



## quick start guide

### Google Home



app Google Home



app Google Home



#### CONTENT

- ▶ Requirements to configure Google Home p. 2
- ▶ Install the Google Home application p. 2
- ▶ Google Home settings p. 2-4



## Requirements to configure Google Home

Before setting up Google Home, make sure that:

- the controllers are configured correctly and can be fully controlled,
- in the controllers, the "Remote Access" option is enabled,
- the controllers have been added to the registered wBox application,
- the domestic WiFi network has a stable internet connection.



## Install the Google Home application

If you have an iOS phone, install and run the Google Home application from the Apple Store

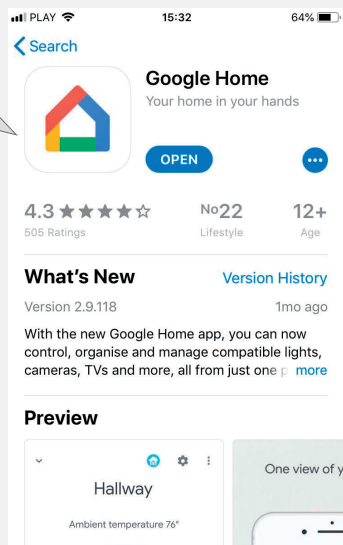

app Google Home



If you have an Android phone, install and run the Google Home application from Google Play

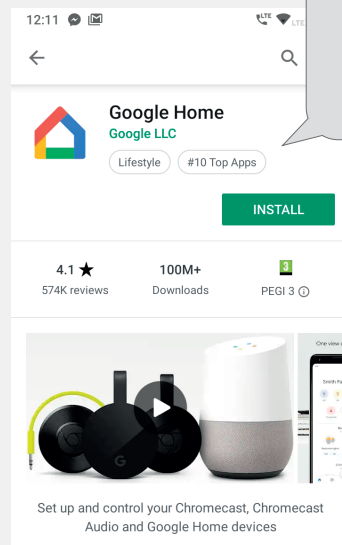

app Google Home



## Google Home settings

1

Start from the creation of a new house

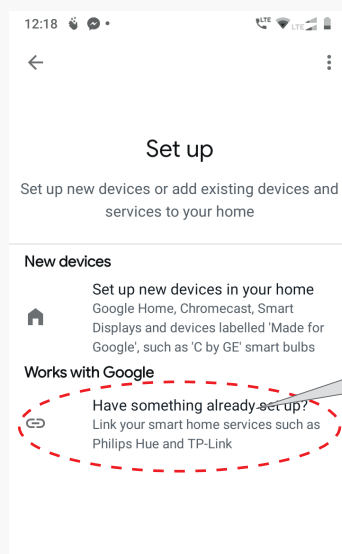
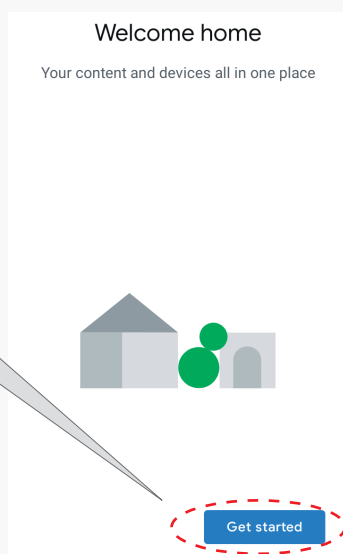

Because the controllers must be previously configured in the wBox application, select the option: "have something already set up?"

2

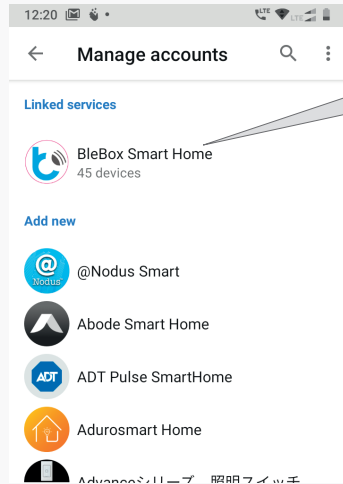

Choose the "BleBox" service

3

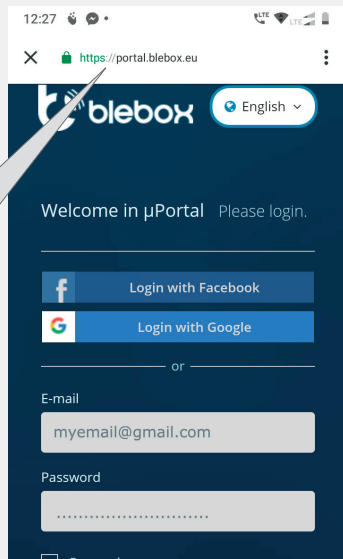

Google Home application automatically redirects to the μPortal login website

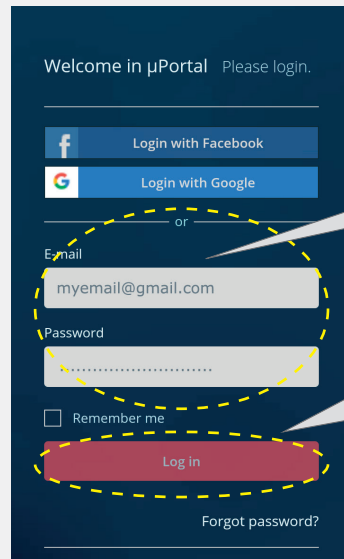

Log in to the system in the same way as for the application wBox

Login

4

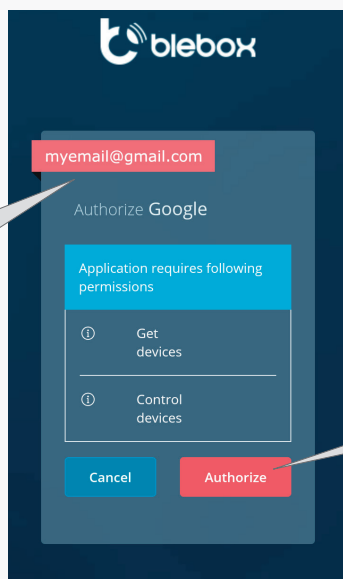

You will log in to your wBox account

Accept the permissions required by Google Home

5

Ready!  
Now you can control  
the devices with your  
voice!

Exit from the  
settings screen  
by pressing  
the X button

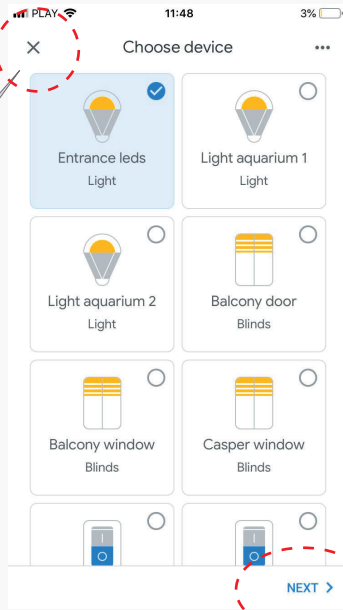

You can also,  
optionally, configure  
virtual rooms  
and assign  
them devices

for more information visit our website

[www.blebox.eu](http://www.blebox.eu)

or send us an email to: [info@blebox.eu](mailto:info@blebox.eu)

support is available at [support@blebox.eu](mailto:support@blebox.eu)